

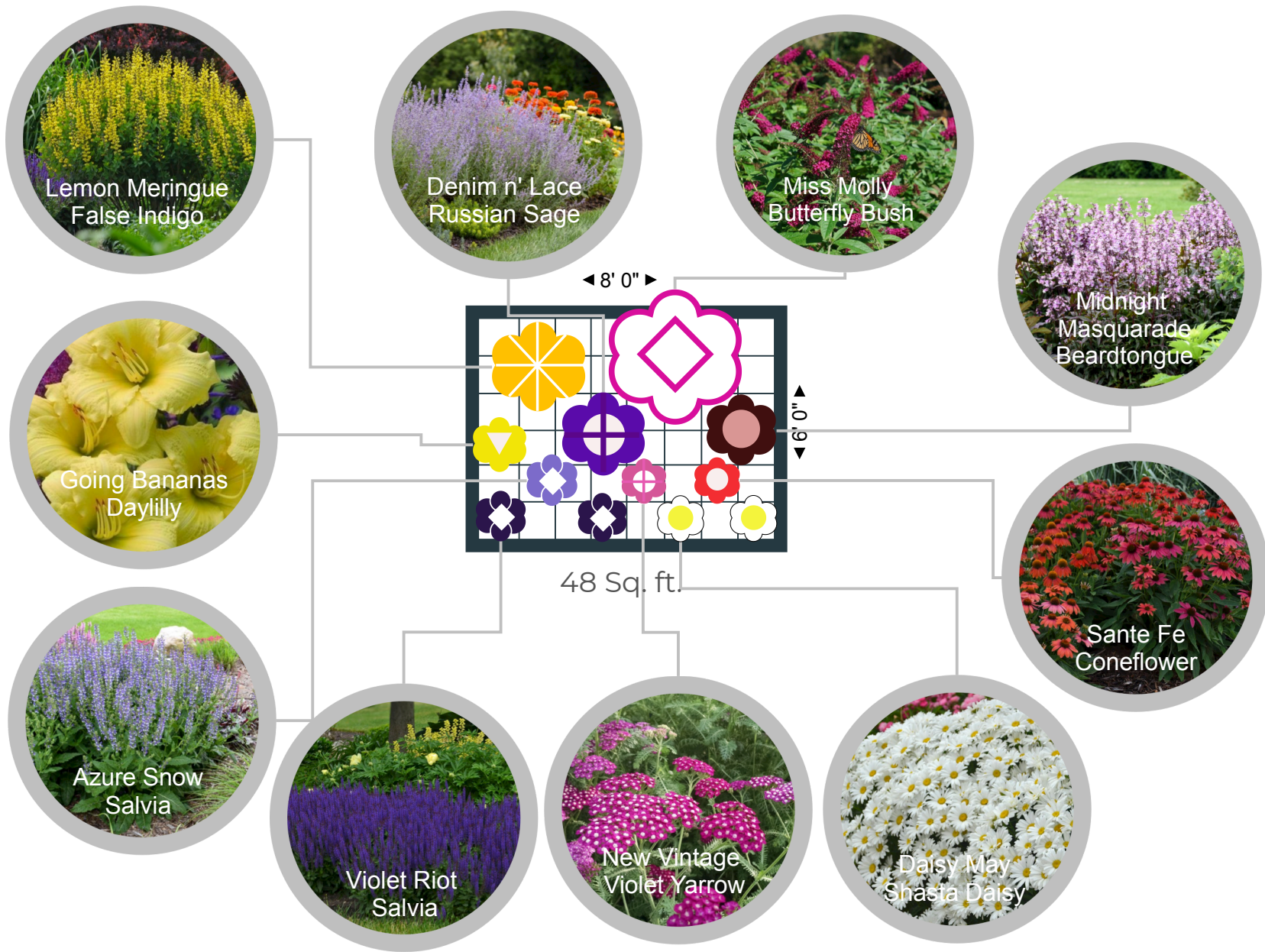



Dry Pollinator Garden for Sun



#	Common Name	Width (Spacing)
2	Daisy May Shasta Daisy	18"
1	Sante Fe Coneflower	18"
2	Violet Riot Salvia	18"
1	New Vintage Violet Yarrow	14"
1	Going Bananas Daylilly	24"
1	Lemon Meringue False Indigo	36"
1	Midnight Masquarade Beardtongue	32"
1	Denim n' Lace Russian Sage	36"
1	Azure Snow Salvia	18"
1	Miss Molly Butterfly Bush	5'

For larger spaces, repeat the design as necessary to fill the space, adjusting the quantities needed when purchasing. The diagram reflects plants at 3/4 mature size. This is a conceptual design to provide general guidelines for your reference and is hardiness zone appropriate for zone 5 or below. Lurvey's is not responsible for the health of the plants or the effect of the garden as installed.